

- LEGEND**
- EX. 1 1/2" OPEN PIPE
 - EX. 1/2" REBAR (UNLESS OTHERWISE NOTED)
 - 1/2" REBAR SET 0.2' BG
 - EX. 4" X 4" CONC. MON.
 - CONC. MON. SET
 - EX. MAG NAIL
 - MAG NAIL SET
 - CALCULATED POINT
 - WATER METER
 - PHONE PEDESTAL
 - LIGHT POST
 - UTILITY POLE
 - GUY WIRE
 - FIRE HYDRANT
 - ELECT. TRANS.
 - AG — ABOVE GRADE
 - BG — BELOW GRADE
 - PL — PROPERTY LINE
 - WATER VALVE
 - WETLAND FLAG

GENERAL NOTES:

(BOUNDARY AND SURVEY INFORMATION BY SEABOARD SURVEYING & PLANNING, INC. DATED 10/25/2019 AND RECORDED IN P.C. J, SL. 107)

1. CURRENT OWNERS: OUTER BANKS DARE CHALLENGE, INC
P.O. BOX 123
WANCHESE, NC 27981
2. RECORDED REFERENCE: P.C. E, SL. 392; D.B. 1892, PG. 252; P.C. B, SL. 203; D.B. 1279, PG. 782
3. EXISTING DARE COUNTY PIN NUMBER: 9798 10 35 2441
4. PARCEL NUMBER: 016520005
5. NFIP FLOOD ZONE: AE (4') SHOWN PER F.I.R.M. MAP #3720979800K EFFECTIVE 6/19/20 (R.F.P.E.=8.0')
6. SITE ZONING: "HWY 345"
7. ALL AREAS BY COORDINATE COMPUTATION.
8. BUILDING SETBACKS SHALL COMFORM WITH THE COUNTY OF DARE ZONING DISTRICT "HWY 345"
9. TOTAL AREA BOTH PARCELS: 156,871 S.F. (3.601 AC.)
10. SOME PORTIONS OF SOME LOTS IN THIS SUBDIVISION ARE LOCATED IN AREAS OF ENVIRONMENTAL CONCERN. INDIVIDUAL PERMITS MAY BE REQUIRED BEFORE DEVELOPMENT MAY TAKE PLACE IN THESE AREAS.

LINE TABLE		
LINE	LENGTH	BEARING
L1	131.15	N70°35'50"E

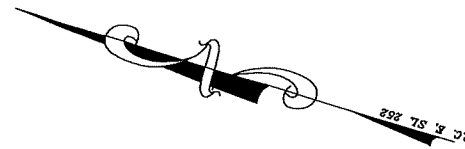

N/F
STATE OF NORTH CAROLINA
(P.C. B, SL. 203)
(D.B. 1279, PG. 782)

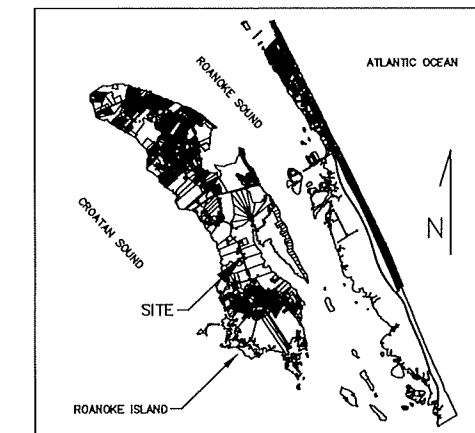

VICINITY MAP
NOT TO SCALE

CUP NOTES:

1. SITE ADDRESS: 2263 NC HWY 345 WANCHESE, NC
2. ZONE: HWY 345
USE (EXISTING & PROPOSED): RESIDENTIAL RECOVERY AND TREATMENT CENTER
3. SCOPE OF PROJECT: DARE CHALLENGE PROPOSES TO EXPAND THE EXISTING RESIDENTIAL FACILITY VIA THE INSTALLATION OF A NEW PROPOSED CENTRAL MULTIPURPOSE BUILDING, TWO PROPOSED DORM BUILDINGS, AND A PROPOSED STAFF BUILDING ALONG WITH ASSOCIATED PARKING, STORMWATER, AND UTILITY INFRASTRUCTURE.
4. ALL PROPOSED BUILDINGS TO BE SINGLE STORY METAL BUILDINGS ON CONCRETE SLAB FOUNDATIONS
5. A USACE FILL PERMIT WILL BE OBTAINED PRIOR TO ANY WORK LOCATED WITHIN USACE JURISDICTIONAL WETLANDS.
6. PARKING: 1 SP/2 BEDS * 64 BEDS = 32 SPACES
(34 PARKING SPACES PROVIDED)
NOTE: PARKING FOR DORMS SERVES AS PARKING FOR MULTIPURPOSE BUILDING. NO ADDITIONAL PARKING REQUIRED.
7. WASTEWATER: SYSTEM A: 2,120 GPD LPP (W/ PRETREATED REPAIR)
PROPOSED DORMITORIES: (2) 16 PERSON DORM
32 PEOPLE * 60 GPD PER PERSON = 1920 GPD
MULTIPURPOSE BUILDING * 3 GPD/PERSON = 5112 GPD
48 PEOPLE * 3 GPD/PERSON = 144 GPD (USE 200 GPD)
SYSTEM B: 960 GPD LPP
PROPOSED DORMITORIES: (1) 16 PERSON DORM
16 PEOPLE * 60 GPD PER PERSON = 960 GPD
EXISTING FACILITY (UNCHANGED)
8. LOT COVERAGE: PARCEL AREA = 156,871 SF

IMPERVIOUS COVERAGE:	3,338 SQ.FT.
EXISTING BUILDINGS & DECKS =	755 SQ.FT.
EXISTING CONCRETE AREAS =	15,224 SQ.FT.
PROPOSED BUILDINGS =	6,370 SQ.FT.
EXISTING GRAVEL =	23,354 SQ.FT.
PROPOSED GRAVEL =	5,117 SQ.FT.
EXISTING CONCRETE =	54,188 SQ.FT. (34.5%)
TOTAL IMPERVIOUS =	(60% ALLOWABLE)

N/F
LOT 2
EXEMPT SUBDIVISION FOR
BROAD CREEK ASSOCIATES
(P.C. E, SL. 392)
(D.B. 1889, PG. 70)

N/F
LOT 2
EXEMPT SUBDIVISION FOR
FOR JOHN P. PIPKIN
(P.C. E, SL. 391)
(D.B. 1889, PG. 70)

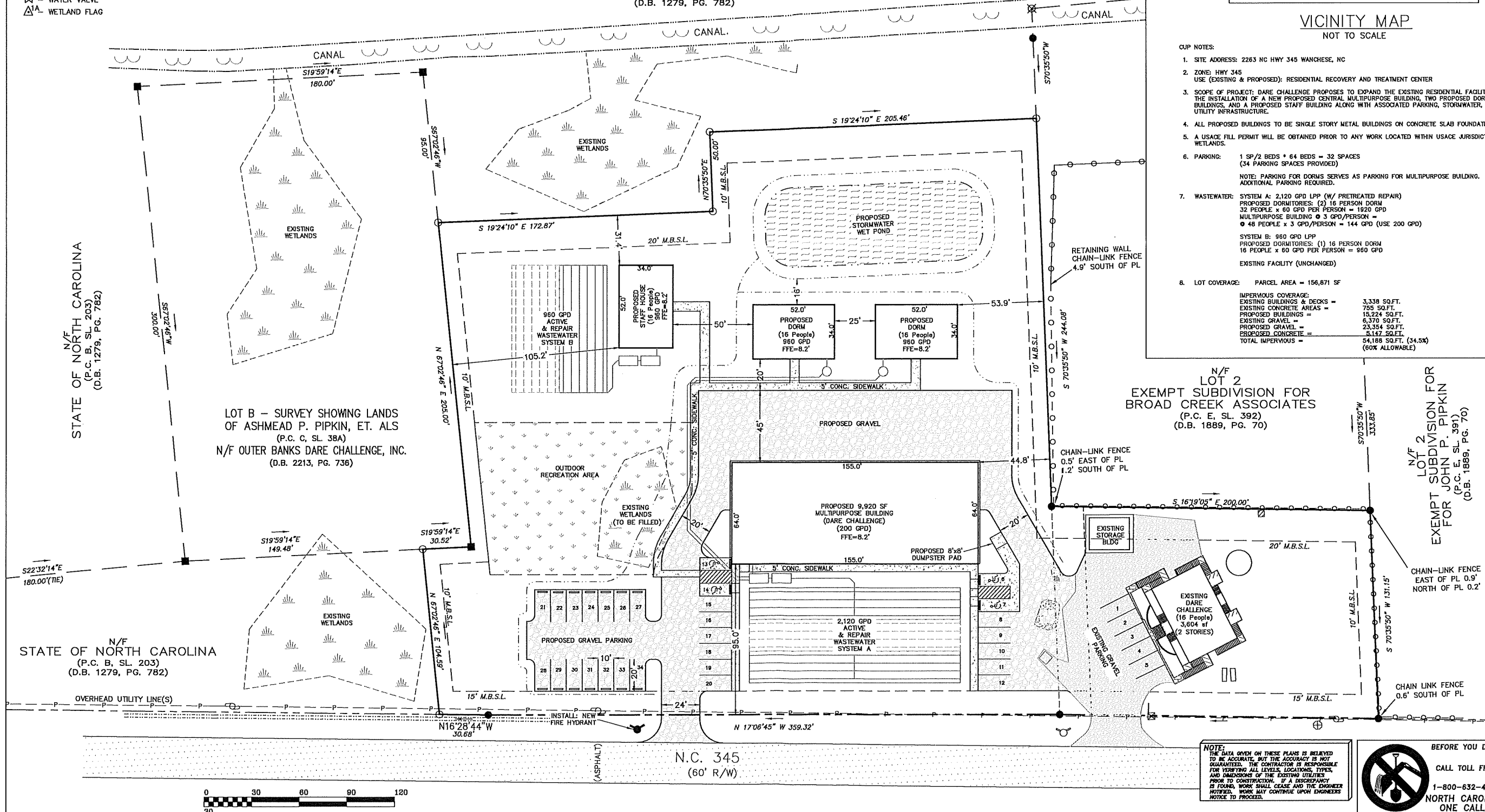

LOT B - SURVEY SHOWING LANDS OF ASHMEAD P. PIPKIN, ET. ALS
(P.C. C, SL. 38A)
N/F OUTER BANKS DARE CHALLENGE, INC.
(D.B. 2213, PG. 736)

N/F
STATE OF NORTH CAROLINA
(P.C. B, SL. 203)
(D.B. 1279, PG. 782)

N.C. 345
(60' R/W)

NOTE:
THE DATA GIVEN ON THESE PLANS IS BELIEVED TO BE ACCURATE, BUT THE ACCURACY IS NOT GUARANTEED. THE CONTRACTOR IS RESPONSIBLE FOR VERIFYING ALL LEVELS, LOCATIONS, TYPES, AND DIMENSIONS OF THE EXISTING UTILITIES PRIOR TO CONSTRUCTION. IF A DISCREPANCY IS FOUND, WORK SHALL CEASE AND THE ENGINEER NOTIFIED. WORK MAY CONTINUE UPON ENGINEER'S NOTICE TO PROCEED.

BEFORE YOU DIG!
CALL TOLL FREE
1-800-632-4949
NORTH CAROLINA
ONE CALL

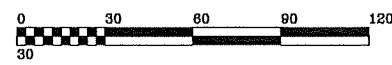

DEEL ENGINEERING, PLLC
CIVIL ENGINEERING SERVICES
FIRM LICENSE P-1045
P.O. BOX 3001
MILL CREEK, NC 27561
Phone: (919) 262-3803 E-mail: deelen@deel.com

COPYRIGHT © 2020 DEEL ENGINEERING, PLLC
THIS DOCUMENT IS THE PROPERTY OF DEEL ENGINEERING, PLLC. ALL RIGHTS ARE RESERVED. ANY REPRODUCTION OF THIS OR ANY PART THEREOF WITHOUT THE WRITTEN PERMISSION OF DEEL ENGINEERING, PLLC IS STRICTLY PROHIBITED AND CONSIDERED A VIOLATION OF COPYRIGHT LAW.

NO.	DATE	REVISIONS

CERTIFICATION
DAVID A. DEEL
Professional Engineer
No. 025156
State of North Carolina

CUP PLAN
OUTER BANKS DARE CHALLENGE
PID: 016520005 PIN: 979800352441
NORTH CAROLINA
DARE COUNTY
WANCHESE

COMMISSION NO.	18007
DESIGNED BY	DAD
DRAWN BY	DAD
CHECKED BY	DAD
ISSUE DATE	11/23/2020

SHEET NO.
P1
OF 1 SHEETS